



Events at EAA



Welcome to EAA!

On behalf of our events team, thank you for considering EAA as your event venue! We are excited at the possibility to work with you to create your event. With more than 1,600 acres and 26 venues to choose from, we are sure to show you a space that will make your vision come to life. From intimate wedding ceremonies and formal corporate meetings, to outdoor runs and exhibitions, EAA can cater to any type of event. Our unique atmosphere is sure to offer a one-of-a-kind experience for your guests.

Starting from initial conversations regarding your specific event needs, to providing hands-on attention throughout, EAA is dedicated to providing you with a premier experience. We take pride in making each event stand out and work with our clients to ensure every detail is fulfilled. Our turnkey approach allows us to create centerpieces, coordinate your audiovisual needs, and work with vendors ranging from musicians and production companies to florists and photographers. Plus, with a list of roughly 12 preferred caterers, you will be sure to find delicious cuisine tailored to meet your event needs.

Please contact our sales manager or your designated event coordinator for any questions you may have, or to move forward with the contract and planning process. Our goal is to ease your workload so come event day, you can enjoy the time with your guests. We look forward to helping you create an event beyond your expectations!

Sincerely,

EAA Events Team



Lori Allman
Events & Sales Manager
(920) 426-6126
lallman@eaa.org



Kelly Zanders
Housing & Event Coordinator
(920) 426-6281
kzanders@eaa.org



Amelia Abraham
Event Coordinator
(920) 426-6510
aabraham@eaa.org

Air Academy Lodge and Staff Lodge

Make this venue your home away from home! The Air Academy Lodge is a great place for corporate retreats, family reunions, weddings, baby showers, or any type of party that requires a relaxed, homey feeling. Complete with 16 guest rooms, a great room, kitchen, dining room, education classrooms, conference rooms, library, fireplace, pool, foosball and ping pong tables, and outdoor facilities including a gazebo with a fire pit, challenge course and volleyball court. The rooms noted below make for great meeting and activity areas within the Air Academy Lodge:

Dimensions:

Sq. Ft.: 50,000

12 bunk rooms with 2 common restrooms upstairs

4 suite rooms with individual restrooms downstairs

Great Room/Dining Room: Seats 54

Conference/Board Room: Seats 8 Conference style

Distance Learning Center: Seats 18 Classroom Style

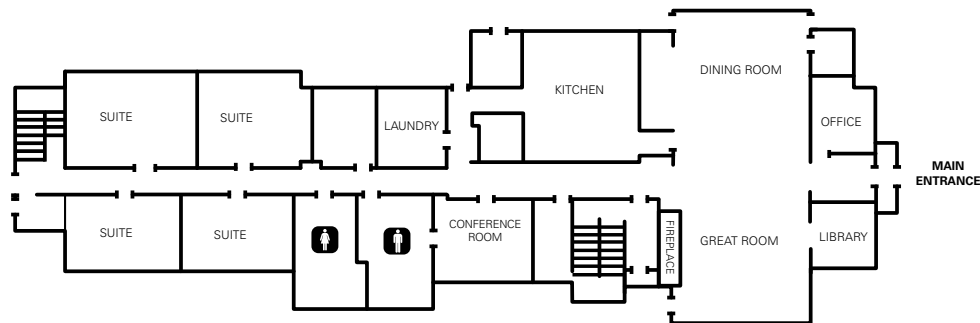

Batten Board Room

Located on the lower level of the EAA Aviation Center, the Batten Board Room offers privacy and comfort in an exceptional meeting facility. It also has full technology capability to accommodate your needs. If desired, you can take the edge off a winter chill or add the right casual touch with an in-room fieldstone fireplace. The Batten Board Room overlooks the Leeward Plaza and Pioneer Airport and is adjacent to the Fergus Plaza.

Rental includes screen and projector.

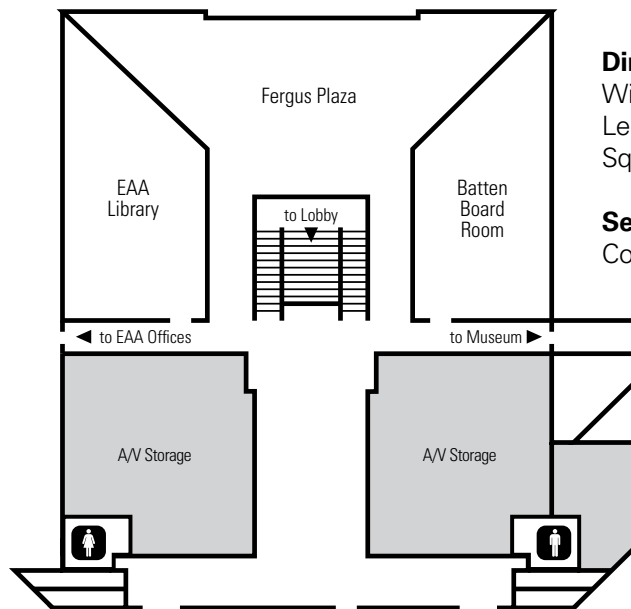

Dimensions

Width: 26'
Length: 40'5"
Sq. Ft.: 873

Seating Capacity

Conference: 26



Computer Lab

If you need to get away from the home office to do important computer or technology training for a small group, this room is the perfect place. The Computer Lab has the technology you need to do small-group training, with an off-the-main-track setting that supplies the quiet training environment your looking for.

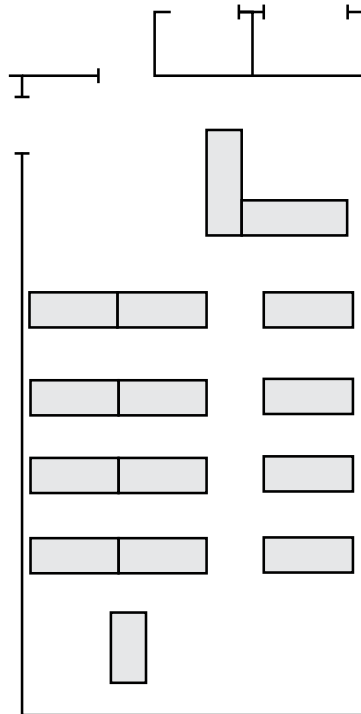

Seating Capacity
Computer Stations: 24



Eagle Hangar

Our largest, and perhaps the most unique space within EAA AirVenture Museum, the Eagle Hangar houses World War II aircraft to create a backdrop of nostalgia. With history, class and space for everything you need at your event from place card and gift tables to bars to a photo booth, this is the perfect venue for all types of events ranging from weddings to corporate meetings.

For groups of more than 300, additional aircraft movement fees may apply. Additional rental may be needed for 500+ people.

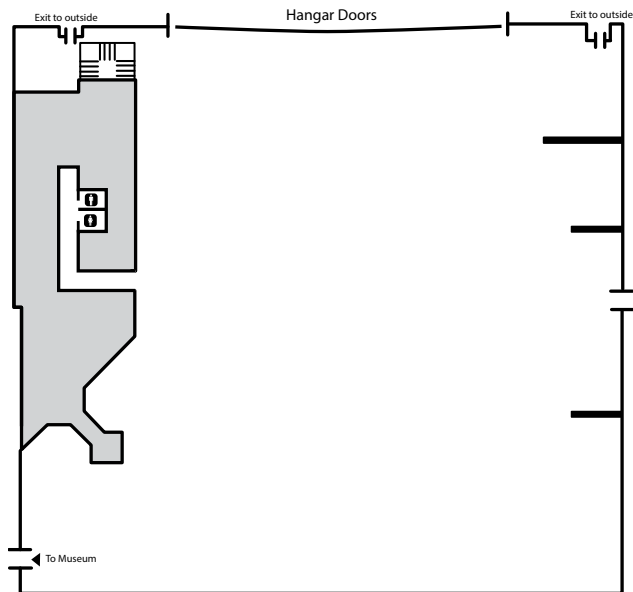

Dimensions

Width: 186'
Length: 186' 10"
Sq. Ft.: 40,000

Seating Capacity

Banquet: 800
Rounds: 700
Theater: 1,000
Classroom: 300



Exhibit Hangars

There are no better convention/exhibit facilities in the area than these four hangars located on the EAA AirVenture grounds. Each summer, the buildings welcome hundreds of aviation exhibitors from around the world and supply their logistical needs. Located close enough together that it's an easy walk to any of them if multiple hangar space is needed, the layout is perfect for organizing your event, convention, festival and show needs with plenty of adjacent parking room and even an aircraft taxiway if needed. Outdoor exhibit space and camping facilities are available upon request.

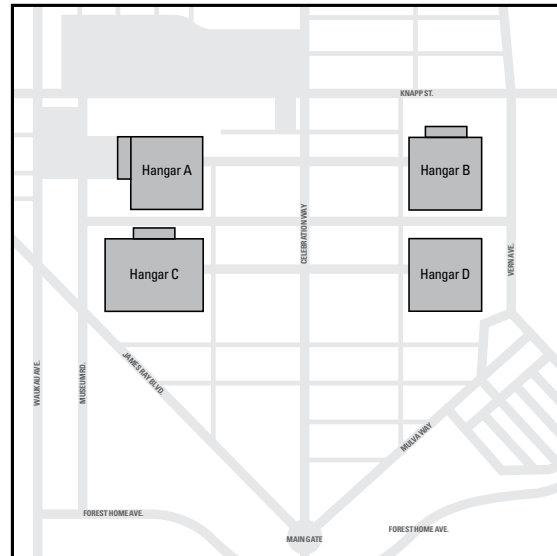

Dinner Banquet/Conference Space	W X L	Square Feet	Banquet	Rounds	Theater	Classroom
Exhibit Hangar A (Heat & Electricity)	200 x 200 ft	40,000	2,500	2,500	4,000	500
Exhibit Hangar B (Restrooms, Heat & Electricity)	200 x 200 ft	40,000	2,500	2,500	4,000	500
Exhibit Hangar C (Restrooms, Heat & Electricity)	200 x 290 ft	58,000	4,000	3,500	6,450	500
Exhibit Hangar D (Heat & Electricity)	200 x 200 ft	40,000	2,500	2,500	4,000	500

Fergus Chapel

A quaint, old-time chapel located next to a quiet pond—the perfect backdrop for beautiful pictures—Fergus Chapel provides an intimate setting for weddings, baptisms or memorial services. The chapel is located between the EAA Nature Center and Pioneer Airport and includes easy, separate access off Waukau Avenue.

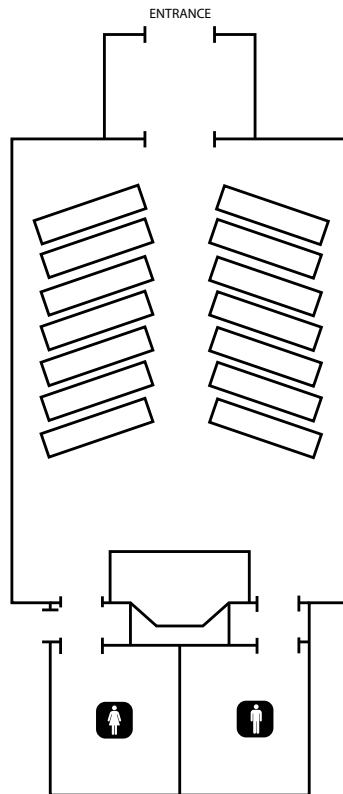

Dimensions

Width: 27'
Length: 39'
Sq. Ft.: 1,026

Seating Capacity

Theater: 80

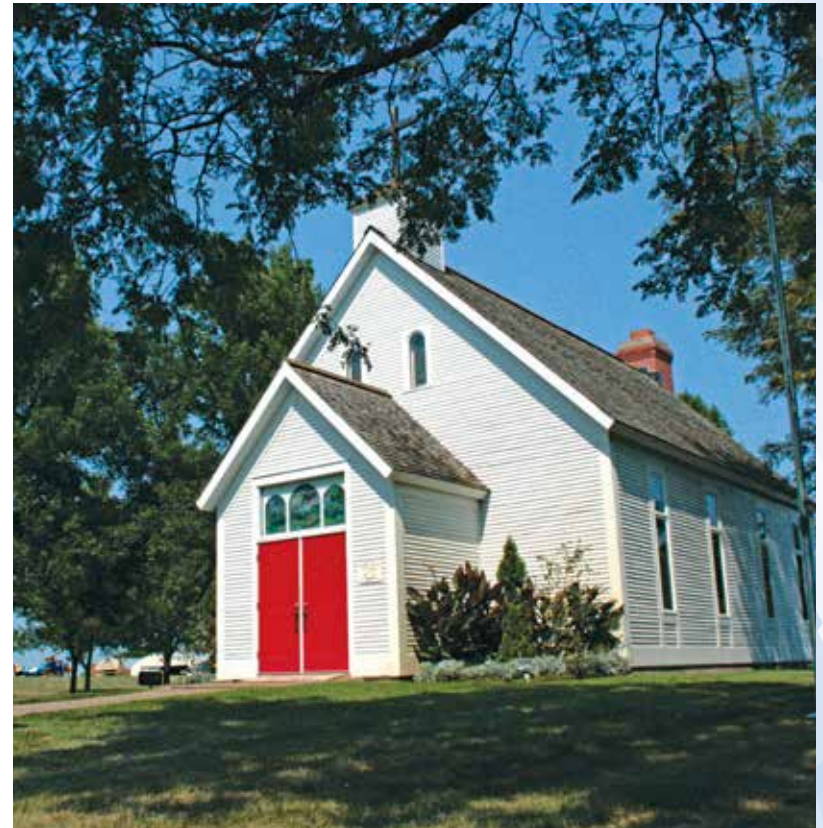

Fergus Plaza

A two-story panoramic view greets guests to the Fergus Plaza, conveniently located on the lower level of the EAA Aviation Center, just inside the main entrance. The view looks out on Leeward Plaza & EAA's Pioneer Airport, a remarkable re-creation of a 1930s aerodrome. Ideal for receptions, private luncheons and after hours events with a catering kitchen located adjacent to Fergus Plaza.

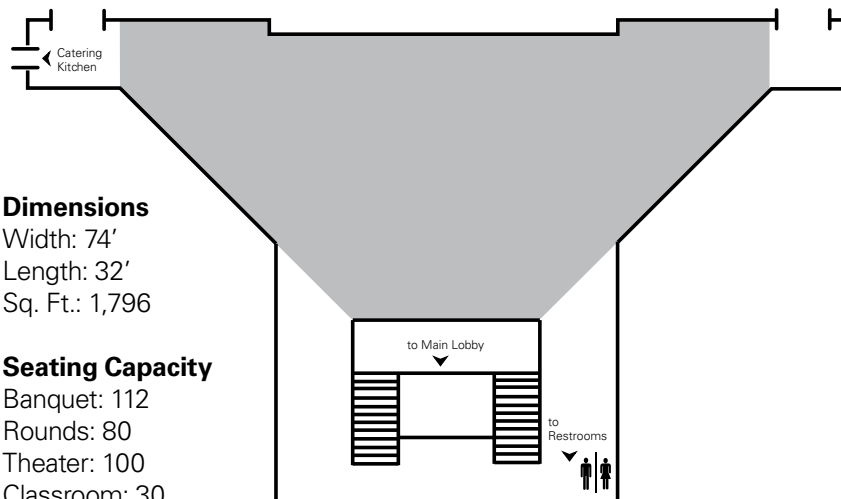

Founders' Wing

Dedicated to preserving EAA's heritage and culture for future generations, the Founders' Wing highlights EAA's significant accomplishments throughout its history. The main floor can accommodate up to 400, surrounding your guests with the history of EAA's annual convention, AirVenture, through the years. An intimate atmosphere awaits on the mezzanine level where your guests can enjoy viewing the Founders' Library and the EAA Legacy Wall while overlooking suspended aircraft, aviation artwork, and displays. Rental includes use of ceiling mounted projector, screen, podium and microphone.

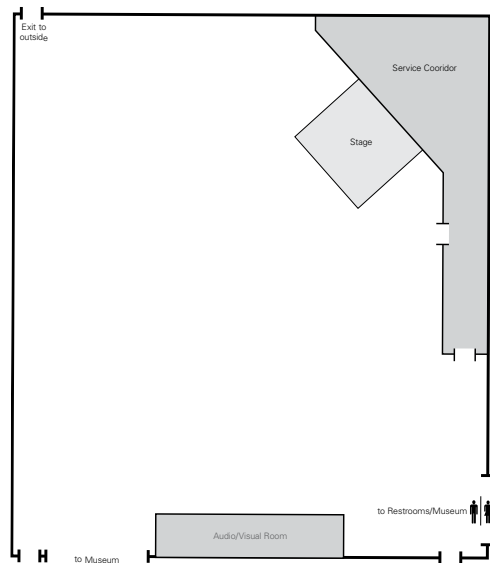

Dimensions

Width: 77' 10"
Length: 95'
Sq. Ft.: 7,400

Seating Capacity

Banquet: 300
Rounds: 240
Theater: 400
Classroom: 100



Leadership Classroom

This outstanding room for classroom presentations, meetings or information sessions includes Internet connections and other updated technology capabilities. The classroom is also an outstanding staging area/"Green Room" for larger events that take place in the Eagle Hangar or other AirVenture Museum areas.

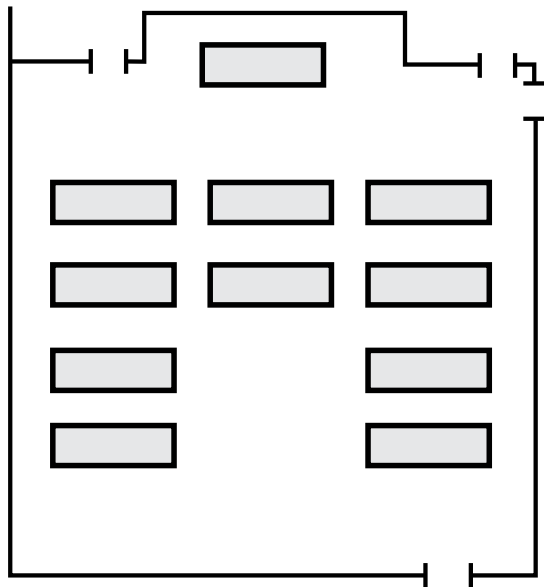

Dimensions

Width: 35' 9"
Length: 36' 2"
Sq. Ft.: 1,326

Seating Capacity

Classroom: 35
Hollow Square: 40



Leeward Plaza

Located just outside the doors of Fergus Plaza, Leeward Plaza is the perfect choice for an informal outdoor reception or lunch. Not only does the location have all the amenities of the adjacent Museum, it also features EAA's Pioneer Airport as a prime view, providing a marvelous aviation backdrop. Convenient drive-up facilities for caterers and other logistics make this an easy area to set up and clean up.

Dimensions

Width: 104'
Length: 64'
Sq. Ft.: 4,480

Seating Capacity

Banquet: 200
Rounds: 160

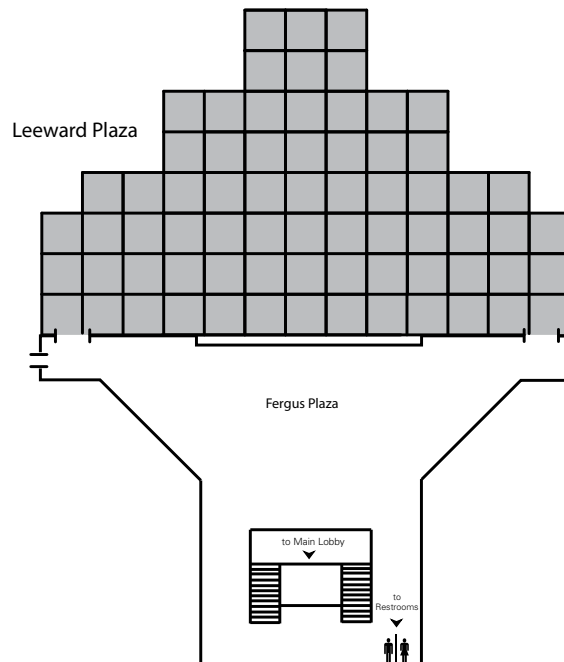

Museum

This is one of the most unique venues available anywhere for meetings, receptions or gatherings. Nearly 100 aircraft are on display throughout the museum, offering much more than the typical gathering area for your group. There are numerous galleries within the EAA AirVenture Museum that provide outstanding backdrops for your event. The price includes access to all areas of the EAA AirVenture Museum. Add a guided museum tour or a Max Flight Simulator ride and make your next function unforgettable!

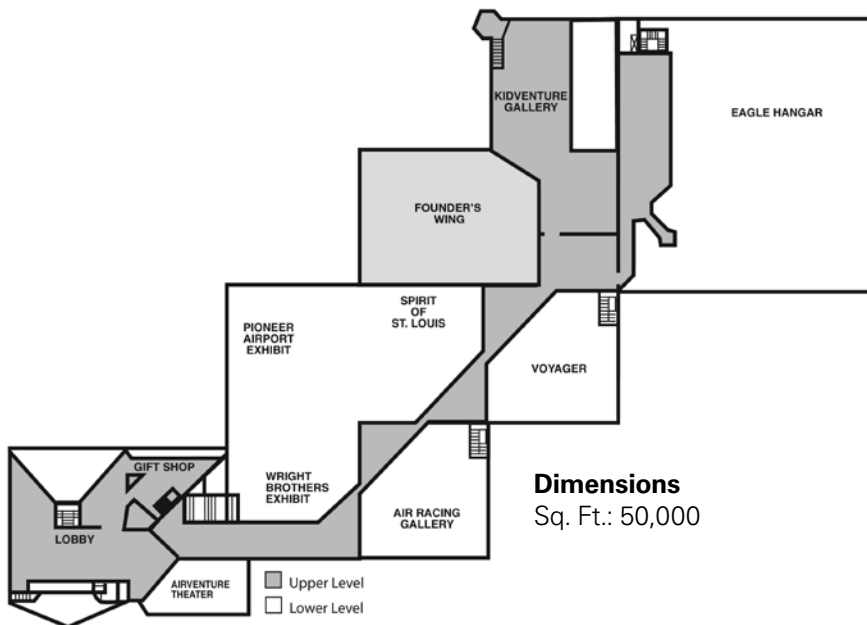

Museum Lobby

The magnificent “Tower of Aviation” welcomes your guests to the EAA Aviation Center, creating a striking setting for any gathering. The lobby is the perfect place for meeting registration and greeting or for hors d’oeuvres and cocktail receptions.

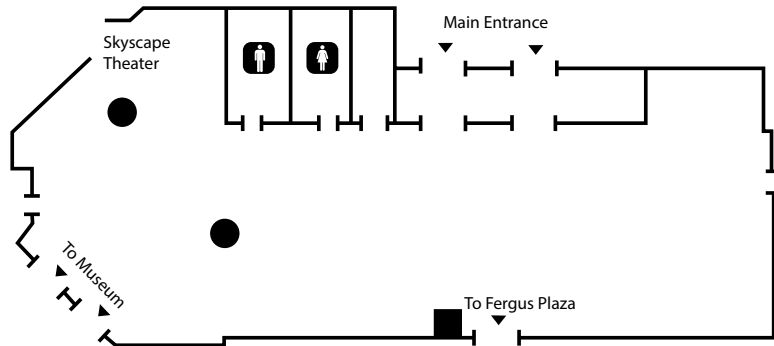

Dimensions

Width: 55' 2"
Length: 124' 4"
Sq. Ft.: 1,500

Seating Capacity

Rounds: 100
Theater: 100



Nature Center

Located east of the EAA Aviation Center in a wooded area, the beautiful pondside Nature Center and Pavilion is the perfect setting for your wedding, company picnic or outdoor event. Along with easy Waukau Avenue access, the Nature Center Pavilion features overhead doors that can bring in or keep out the weather. The pavilion is surrounded by an open area for parking or group activities.

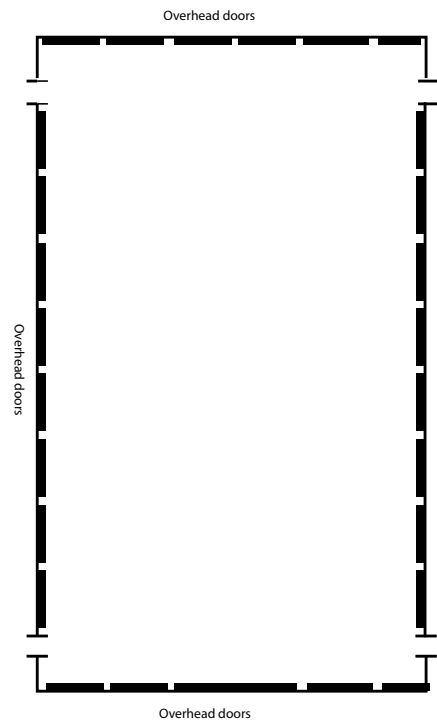

Dimensions

Width: 60'
Length: 100'
Sq. Ft.: 6,000

Seating Capacity

Banquet: 300
Rounds: 300
Theater: 500
Classroom: 100



Vette Theater

Our state-of-the-art amphitheater can accommodate major video presentations with comfortable theatre seating for 116. Each seat also has a slide-away writing surface, making it the ideal setting for meetings or presentations. A private stairway entrance can be used to reach the facility. Rental includes use of data projector, screen, podium and microphone. Additional audio/visual equipment available.

Restrictions: Food and beverage are not allowed in the Vette Theatre

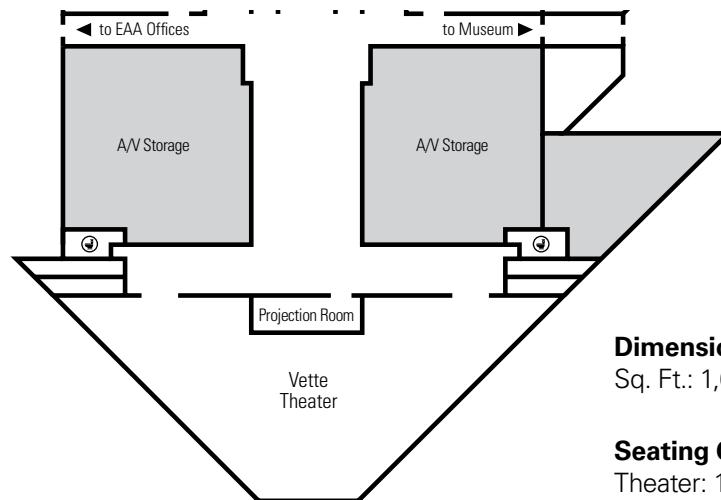

Dimensions
Sq. Ft.: 1,667

Seating Capacity
Theater: 116



Approved Caterers

Becket's

1 City Center, Oshkosh, WI 54901
Contact: Kris Larson or Mike Buckarma
(920) 230.3333
kris@becketsrestaurant.com
mike@becketsrestaurant.com

Best Western Premier Waterfront Hotel & Convention Center

1 North Main Street, Oshkosh, WI 54901
Contact: Christy Marquardt
(920) 230.6289 | cmarquardt@bwoshkosh.com

Hilton Garden Inn

1355 West 20th Avenue, Oshkosh, WI 54902
Contact: Mary Charles
(920) 966.1300 | mary.charles@hilton.com

LaSure's

1570 Ripon Lane, Oshkosh, WI 54901
Contact: Talia Stone
(920) 651.0796 | talias@lasures.com

Machine Shed Restaurant

220 N. Fox River Drive
Grand Chute, WI 54913
Contact: Jason Schroeder
(920) 830.2326 | jschroeder@hoari.com

Red's Pizza & Catering

1123 Oregon Street, Oshkosh WI, 54902
Contact: Steve Lawler
(920) 231.3290 | redspizza@new.rr.com

The Roxy

571 N. Main Street, Oshkosh, WI 54901
Contact: Ryan Wolf
(920) 379.5622 | theroxy@ntd.net

Saz's Catering

5539 West State Street, Milwaukee, WI 53208
Contact: Joe Brueggemann and Mike Salazar
(414) 256.8765 | joeb@sazs.com | msalazar@sazs.com

Sodexo

300 Seward Street, Ripon, WI 54971
Contact: Doug Warpinski
(920) 748.8170 | warpinskid@ripon.edu

Thunder Bay

N14W24130 Tower Place, Waukesha, WI 53188
Contact: Terry Waite
(262) 523.4244 | twaite@hoari.com

Tysinger Promotions (TPI)

PO Box 12588, 601 McCarthy Blvd., New Bern, NC 28561
Contact: Wendy Stallings
(252) 636.0033 | wendy@tysingerpromotions.com



*ALL alcoholic beverage service
must be contracted through EAA .*

Beverages (Premium Bar)



Cocktails	Hosted Price	Cash Price
Smirnoff	\$4.75	\$5.00
Tanqueray	\$4.75	\$5.00
Dewar's	\$4.75	\$5.00
Jim Beam	\$4.75	\$5.00
Southern Comfort	\$4.75	\$5.00
Bacardi Silver	\$4.75	\$5.00
Captain Morgan	\$4.75	\$5.00
Malibu	\$4.75	\$5.00
Canadian Club	\$4.75	\$5.00
Jose Cuervo	\$4.75	\$5.00
Christian Brothers	\$4.75	\$5.00
M&R DryVermouth	—	—
M&R Sweet Vermouth	—	—
Wines		
Copperidge Chardonnay	\$5.00	\$5.00
Copperidge Cabernet	\$5.00	\$5.00
Copperidge Merlot	\$5.00	\$5.00
Copperidge White Zinfandel	\$5.00	\$5.00
Twisted Pinot Grigio	\$5.00	\$5.00
Columbia Riesling	\$5.00	\$5.00
Sparkling		
Wycliff Bubbly Brut	\$15.00	\$15.00
Domestic Beer		
Miller Lite	\$3.50	\$3.50
MGD	\$3.50	\$3.50
Miller 64	\$3.50	\$3.50

Premium Beer	Hosted Price	Cash Price
Leinenkugel's Honeyweiss	\$4.50	\$4.50
Leinenkugel's Sunset Wheat	\$4.50	\$4.50
Capital Island Wheat	\$4.50	\$4.50
Capital WI Amber	\$4.50	\$4.50
Corona	\$4.50	\$4.50
Sam Adams Lager	\$4.50	\$4.50
Barrel Service		
1/2 Barrel Domestic	\$235.00	—
1/2 Barrel Premium	\$275.00	—
Non-Alcoholic Beer		
Sharps	\$3.00	\$3.50
Bottled Water		
Aquafina	\$1.50	\$1.50
Soft Drinks		
Pepsi	\$1.50	\$1.50
Diet Pepsi	\$1.50	\$1.50
Sierra Mist	\$1.50	\$1.50

Please add 18% service charge and applicable sales tax. There is a \$100 bartender fee for each bartender required.

Selections subject to change.

Beverages (Deluxe Bar)



Cocktails	Hosted Price	Cash Price
Absolut	\$5.25	\$5.50
Bombay Sapphire	\$5.25	\$5.50
J.Walker Red	\$5.25	\$5.50
Makers Mark	\$5.25	\$5.50
Southern Comfort	\$5.25	\$5.50
Bacardi Silver	\$5.25	\$5.50
Bacardi 8	\$5.25	\$5.50
Malibu	\$5.25	\$5.50
Crown Royal	\$5.25	\$5.50
Sauza Hornitos Reposado	\$5.25	\$5.50
Korbel Brandy	\$5.25	\$5.50
M&R DryVermouth	—	—
M&R Sweet Vermouth	—	—
Wines		
Domino Chardonnay	\$5.50	\$6.00
Domino Cabernet	\$5.50	\$6.00
Domino Merlot	\$5.50	\$6.00
Beringer White Zinfandel	\$5.50	\$6.00
Twisted Pinot Grigio	\$5.50	\$6.00
Columbia Riesling	\$5.50	\$6.00
Sparkling		
Wycliff Bubbly Brut	\$15.00	\$15.00
Domestic Beer		
Miller Lite	\$3.50	\$3.50
MGD	\$3.50	\$3.50
Miller 64	\$3.50	\$3.50

Premium Beer	Hosted Price	Cash Price
Leinenkugel's Honeyweiss	\$4.50	\$4.50
Leinenkugel's Sunset Wheat	\$4.50	\$4.50
Capital Island Wheat	\$4.50	\$4.50
Capital WI Amber	\$4.50	\$4.50
Corona	\$4.50	\$4.50
Sam Adams Lager	\$4.50	\$4.50
Barrel Service		
1/2 Barrel Domestic	\$235.00	-
1/2 Barrel Premium	\$275.00	-
Non-Alcoholic Beer		
Sharps	\$3.00	\$3.50
Bottled Water		
Aquafina	\$1.50	\$1.50
Soft Drinks		
Pepsi	\$1.50	\$1.50
Diet Pepsi	\$1.50	\$1.50
Sierra Mist	\$1.50	\$1.50

Please add 18% service charge and applicable sales tax. There is a \$100 bartender fee for each bartender required.

Selections subject to change.

